

Fibo

Fibo | A smart way to transform your wall

Fibo Waterproof Wall System - Made for Modular Housing



LISTED

LAMINATED PANEL
R39061
LISTED IN ACCORDANCE WITH
CAN/ULC-S102



CLASSIFIED

UL

BUILDING UNITS
R39061



Fibo – a reliable and solid partner



Experts on wet rooms and demanding walls

- Key focus on innovation and development of the best solutions for the most challenging rooms
- A pioneer in developing effective solutions for modern wet rooms
- Manufacturing high-quality wall systems since 1952

Market leader in wall systems

- Strong presence in Europe with ambitions for global growth
- More than 1 million installations completed and more than 160 million m2 delivered in the past 10 years

Hi-tech production with stringent quality controls

- Fibo-owned and controlled production and development process with factory in Lyngdal, Norway
- Robust owners who have invested more than NOK 140 million in state-of-the-art technology
- Named LEAN business of the year in Norway multiple times ISO 9001:2015-certified

Fibo – a unique and complete solution for modular housing

A complete product solution

- Unique design with modern wall solutions for today's trends
- Selected raw materials and product composition ensure a robust and 100% watertight product
- Complete system with customised accessories and profiles for a perfect result
- Fibo's patented Aqualock system and large surfaces mean fast and easy installation

Cost-effective

- Save up to 50% thanks to significantly quicker installation and fewer materials
- Fewer processes and tradespeople during installation mean reduced downtime and business disruption

Satisfies all standards and regulations

- Tested and approved according to prevailing building regulations and provided with a warranty

Extensive experience and expertise

- A pioneer in developing effective solutions for modern wet rooms
- We know how the trades work and partner with them to develop the system
- Support and advanced training systems available

Sustainable and eco-friendly end product

- PEFC-certified timber and all necessary eco-certifications
- Helps store carbon from the atmosphere
- Long service life and easy maintenance



World class wall panels

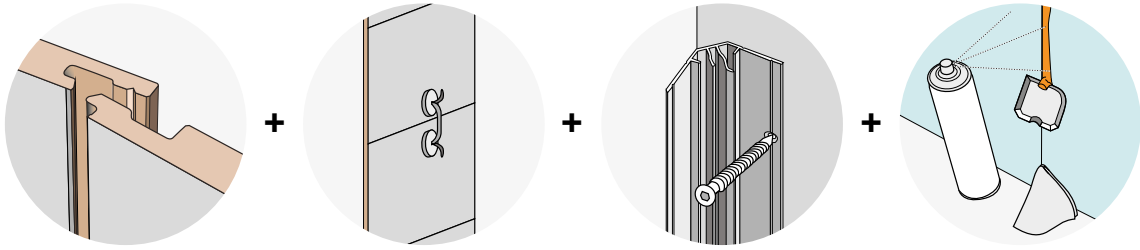

With Fibo you get a safe solution that is 100% waterproof and has all the necessary approvals for wet rooms. The system is delivered as a complete set of accessory products and profiles, which simplifies the assembly job and ensures a perfect and safe result.

- Ongoing development and testing of raw materials combined with tried and tested production methods help optimise quality and create a robust product
- Unique combination of birch ply and high-pressure laminate ensures a solid and hard-wearing product
- The robust high-pressure laminate creates a 100% watertight surface that withstands direct shower spray and significant temperature swings
- Unique and refined click lock system – Fibo Aqualock – simplifies installation and leaves virtually invisible joints between the panels



Case studies

- Why other companies working with modular housing have chosen Fibo.

DE WIT CHALETS

“A bathroom decorated with Fibo is less vulnerable during transport of the mobile homes, compared to traditional tiles which often crack or tear.”

Peter Starreveld, Owner/Director, De Wit Chalets



“When we speak to clients who have been living in their homes for a while already, we often hear that Fibo is such an easy product to clean. The service that RET Bouwproducten offers is simply great.”

Advantages

- The possibility to “walk away” during the installation process, to get another panel
- Applied dry and clean
- A varied range of decors

Client

De Wit Chalets

ESTEC GMBH & CO. KG



“The Fibo system has been very well received by our customers. We are very optimistic about using Fibo in future projects.”

Udo Scharr, Sales ESTEC GmbH & Co

Client feedback

- The product training as well as the general product quality are outstanding.

Advantages

- The fact that the Fibo system is 100% waterproof as well as the quick installation
- The large range of designs have great esthetic appeal

Client

ESTEC GmbH & Co

AMOVEO

“Replacing ceramic wall tiling with Fibo resulted in a significant improvement to the efficiency and throughput of our production line. Fibo fundamentally changed for the better the way I consider the adoption of new materials and methodologies!”

John Annear, Registered Builder, Amoveo Pty Ltd, Australia

Advantages

- Fewer trades required, which has meant that on some projects we no longer need Tilers.
- In a single application we can line, waterproof and finish a wet area wall, resulting in a reassignment of two bays to improve productivity.
- Time previously lost while waiting for membranes to cure, which represented a significant production risk during periods of high humidity, were no longer an issue.
- The ease and speed of fitting off fixtures without the need to pre-drill is a big productivity gain.



- For most fixings there is no need to noggin-out the frame as the Fibo panel easily supports robe hooks, towel rails, shower screen channels and toilet roll holders thereby reducing materials and weight
- **With Fibo we have far less in-transit damage compared to ceramic tiles, which can chip, pop out or crack.**

LOCAL HOMES, WALSALL FACTORY

“As a modular build, products that were quick and easy to install were essential, but with no compromise on quality!”



Advantages

- Quick and easy to install
- Good quality

Client

Local Homes - low carbon living

Product/delivery

- Marcato - EM Grey Concrete
- Legato - S White

Made for modular

The Fibo Wall System is well suited to the volumetric modular manufacturing process. It is simple and quick to install and save time.



Quick and easy

60–65% fewer working hours when fitting Fibo wall system vs. tiles

Few processes from start to finished wall

- Fits directly onto studwork and other existing walls
- Membrane in front of panel

Efficient worksite

- Fewer tradespeople involved
- No waiting time – the job can be done in one go until finished
- No waiting around for membrane, adhesive or grouting to dry and harden
- Fewer materials and less waste

Easy to fit

- Entire panels click together and lock with Fibo Aqualock
- Complete system



Cost-effective

35–50% savings when using Fibo wall system vs. tiles

Reduced loss of income as a result of faster completion

Cost-savings thanks to efficient maintenance

- Panels can easily be replaced without having to fit new substrate, new membrane etc.
- Smooth, even surfaces mean quicker cleaning

Easy and inexpensive waste disposal

50% lower weight of Fibo vs. tiles generates transport and environmental savings.





A smart way to transform your wall

- Inspirational design and a wide range of options
- Safe solutions that are 100% waterproof and perfect for high usage areas
- Quick & easy installation with Fibo Aqualock and accessories to ensure the total system solution and an optimal result
- Durability by means of a surface hardness that better resists wear and tear.
- Cost effective products that provide value for money

Explore more at www.fibosystemUSA.com

FIBO USA, LLC

160 Greentree Drive
Suite 101
Dover, Delaware 19904

Tel.: 1-617-416 7180
E-mail: info@fibosystem.com

© @designbyfibo